

L-M



L-M range of connectors are designed for jointing low voltage conductors.

Made of electrolytic Copper tube with a purity greater than 99.9%, having the same dimension as A-M series lugs: L-M connectors are annealed and electrolytically Tin plated. They feature an internal taper at both ends to ease the introduction of the conductor and a central stop to ensure correct positioning.

Details of the appropriate crimping tools and dies are shown on pages 248 to 249.

THROUGH CONNECTORS

for Copper conductors

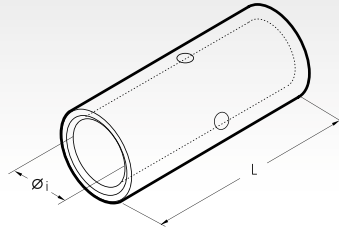

Conductor Size sqmm		Type	Dimensions mm		Quantity Box/Bag	Mechanical Tools	Hydraulic Tools
Low Stranded	Flexible		Øi	L			
0,25÷1,5	0,25÷1,5	L03-M*	1,8	15	6.000/100	HN1 HN5 HN-A25 TN70SE TN120 SE* B15MD HT45-E B450ND-BV HT51 RH50 B500ND HT61 RH61 B600 HT81-U RHU81 HT120 and tools and heads with 130 kN crimping force ECW-H3D RHU520	
1,5÷2,5	1,5÷2,5	L06-M*	2,4	15	4.000/100		
4÷6	4÷6	L1-M	3,6	22	2.000/100		
10	10	L2-M	4,6	25	1.000/100		
16	16	L3-M	5,8	27	500/100		
25	25	L5-M	7,0	29	500/100		
35	25÷35	L7-M	8,9	33	400/100		
50	35÷50	L10-M	10,0	37	200/50		
70	50÷70	L14-M	11,3	39	200/50		
95	70÷95	L19-M	13,5	43	100/25		
120	95÷120	L24-M	15,2	47	75/25		
150	120÷150	L30-M	16,7	58	50/25		
185	150÷185	L37-M	19,2	64	30/15		
240	185÷240	L48-M	21,1	75	20/10		
300	240÷300	L60-M	23,7	90	20/10		
400	300÷400	L80-M	27,0	94	15/5		
500	400÷500	L100-M	30,3	98	12/1		
630	500÷630	L120-M*	33,4	105	10/1		
800	600	L160-M*	38,0	112	9/1		
1000	800	L200-M*	44,0	120	6/1		

*See page 135

L-P



Made of electrolytic Copper tube with a purity greater than 99.9%, having the same dimensions as A-M series lugs, L-P connectors are annealed and electrolytically Tin plated.

They feature an internal taper to ease the introduction of the conductor.

Details of the appropriate crimping tools and dies are shown on pages 248 to 249.

PARALLEL CONNECTORS

for Copper conductors

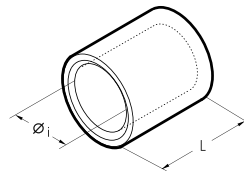

Total Conductor Size sqmm		Type	Dimensions mm		Quantity Box/Bag	Mechanical Tools	Hydraulic Tools
Low Stranded	Flexible		Øi	L			
0,25÷1,5	0,25÷1,5	L03-P	1,8	6,0	8.000/100	HN1 HN5 HN-A25 TN70SE TN120 SE* B15MD HT45-E B450ND-BV HT51 RH50 B500ND HT61 RH61 B600 HT81-U RHU81 HT120 and tools and heads with 130 kN crimping force ECW-H3D RHU520	
1,5÷2,5	1,5÷2,5	L06-P	2,4	6,0	5.000/100		
4÷6	4÷6	L1-P	3,6	9,0	3.000/100		
10	10	L2-P	4,6	10,5	3.000/100		
16	16	L3-P	5,8	11,5	2.000/100		
25	25	L5-P	7,0	13,0	1.000/100		
35	25÷35	L7-P	8,9	14,0	500/100		
50	35÷50	L10-P	10,0	16,0	500/100		
70	50÷70	L14-P	11,3	18,0	500/100		
95	70÷95	L19-P	13,5	19,0	200/50		
120	95÷120	L24-P	15,2	22,0	200/50		
150	120÷150	L30-P	16,7	26,5	100/50		
185	150÷185	L37-P	19,2	26,5	100/50		
240	185÷240	L48-P	21,1	34,0	60/15		
300	240÷300	L60-P	23,7	43,0	50/25		

*See page 135

*Not UL approved