

COPPER TUBE CRIMPING LUGS ACCORDING TO DIN 46235

for Copper conductors

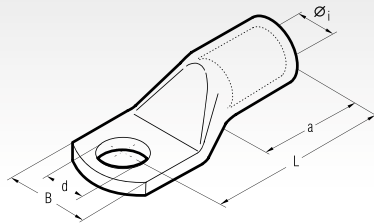

| Conductor Size sqmm | Ø Stud mm | Type | Code | Dimensions mm | | | | | Quantity Box/Bag | Hydraulic Tools | | |
|---------------------|-----------|-----------|------|---------------|------|-------|------|-------|------------------|------------------|------------------------------------------------------|----------------|
| | | | | Øi | d | L | B | a | | RH50 B500 B500ND | HT120 and tools and heads with 130 kN crimping force | ECW-H3D RHU520 |
| 300 | 12 | DR300-12* | 32 | 24,5 | 13,0 | 104,0 | 47,0 | 50,0 | 10/5 | | | |
| | 16 | DR300-16 | 32 | 24,5 | 17,0 | 100,0 | 48,0 | 50,0 | 10/5 | | | |
| | 20 | DR300-20 | 32 | 24,5 | 21,0 | 100,0 | 47,0 | 50,0 | 10/5 | | | |
| 400 | 12 | DR400-12* | 38 | 27,5 | 13,0 | 117,0 | 55,0 | 70,0 | 5/5 | | | |
| | 16 | DR400-16 | 38 | 27,5 | 17,0 | 117,0 | 55,0 | 70,0 | 5/5 | | | |
| | 20 | DR400-20 | 38 | 27,5 | 21,0 | 117,0 | 55,0 | 70,0 | 5/5 | | | |
| 500 | 12 | DR500-12* | 42 | 31,0 | 13,0 | 130,0 | 60,0 | 70,0 | 5/5 | | | |
| | 16 | DR500-16* | 42 | 31,0 | 17,0 | 130,0 | 60,0 | 70,0 | 5/5 | | | |
| | 20 | DR500-20 | 42 | 31,0 | 21,0 | 130,0 | 60,0 | 70,0 | 5/5 | | | |
| 625 | 20 | DR625-20 | 44 | 34,5 | 21,0 | 135,0 | 63,0 | 80,0 | 5/5 | | | |
| 800 | 20 | DR800-20 | 52 | 40,0 | 21,0 | 166,0 | 75,0 | 100,0 | 5/5 | | | |
| 1.000 | 20 | DR1000-20 | 58 | 44,0 | 21,0 | 166,0 | 85,0 | 100,0 | 5/5 | | | |

* Dimensions of the tube according to DIN 46235; Stud hole not included within the standard.

DR



Consult us for special requirements

CRIMPING THROUGH CONNECTORS ACCORDING TO DIN 46267 T.1

for Copper conductors

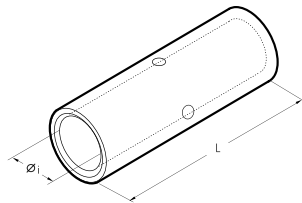

| Conductor Size sqmm | Type | Code | Dimensions mm | | Quantity Box/Bag | Mechanical Tools | Hydraulic Tools | | | | | | | |
|---------------------|---------|------|---------------|-----|------------------|------------------|-----------------|------------------|------------------|----------------|------------------------------------------------------|------------------------------------------------------|----------------|-------|
| | | | Øi | L | | | HT45-E | RH50 B500 B500ND | HT61 RH61 B600 | HT81-U RHU81 | HT120 and tools and heads with 130 kN crimping force | ECW-H3D RHU520 | | |
| 6 | DSV6 | 5 | 3,7 | 30 | 1.200/100 | HN-D25 | | | | | | | TND6-70 | B15MD |
| 10 | DSV10 | 6 | 4,4 | 30 | 1.200/100 | | | | | | | | | |
| 16 | DSV16 | 8 | 5,5 | 50 | 400/100 | TND10-120 | B15MD | HT45-E | RH50 B500 B500ND | HT61 RH61 B600 | HT81-U RHU81 | HT120 and tools and heads with 130 kN crimping force | ECW-H3D RHU520 | |
| 25 | DSV25 | 10 | 7,0 | 50 | 200/100 | | | | | | | | | |
| 35 | DSV35 | 12 | 8,2 | 50 | 200/100 | TND10-120 | B15MD | HT45-E | RH50 B500 B500ND | HT61 RH61 B600 | HT81-U RHU81 | HT120 and tools and heads with 130 kN crimping force | ECW-H3D RHU520 | |
| 50 | DSV50 | 14 | 10,0 | 56 | 200/50 | | | | | | | | | |
| 70 | DSV70 | 16 | 11,5 | 56 | 100/50 | TND10-120 | B15MD | HT45-E | RH50 B500 B500ND | HT61 RH61 B600 | HT81-U RHU81 | HT120 and tools and heads with 130 kN crimping force | ECW-H3D RHU520 | |
| 95 | DSV95 | 18 | 13,5 | 70 | 100/50 | | | | | | | | | |
| 120 | DSV120 | 20 | 15,5 | 70 | 50/25 | TND10-120 | B15MD | HT45-E | RH50 B500 B500ND | HT61 RH61 B600 | HT81-U RHU81 | HT120 and tools and heads with 130 kN crimping force | ECW-H3D RHU520 | |
| 150 | DSV150 | 22 | 17,0 | 80 | 50/25 | | | | | | | | | |
| 185 | DSV185 | 25 | 19,0 | 85 | 25/25 | TND10-120 | B15MD | HT45-E | RH50 B500 B500ND | HT61 RH61 B600 | HT81-U RHU81 | HT120 and tools and heads with 130 kN crimping force | ECW-H3D RHU520 | |
| 240 | DSV240 | 28 | 21,5 | 90 | 15/15 | | | | | | | | | |
| 300 | DSV300 | 32 | 24,5 | 100 | 10/5 | TND10-120 | B15MD | HT45-E | RH50 B500 B500ND | HT61 RH61 B600 | HT81-U RHU81 | HT120 and tools and heads with 130 kN crimping force | ECW-H3D RHU520 | |
| 400 | DSV400 | 38 | 27,5 | 150 | 10/5 | | | | | | | | | |
| 500 | DSV500 | 42 | 31,0 | 160 | 5/5 | TND10-120 | B15MD | HT45-E | RH50 B500 B500ND | HT61 RH61 B600 | HT81-U RHU81 | HT120 and tools and heads with 130 kN crimping force | ECW-H3D RHU520 | |
| 625 | DSV625 | 44 | 34,5 | 160 | 5/5 | | | | | | | | | |
| 800 | DSV800 | 52 | 40,0 | 200 | 5/5 | TND10-120 | B15MD | HT45-E | RH50 B500 B500ND | HT61 RH61 B600 | HT81-U RHU81 | HT120 and tools and heads with 130 kN crimping force | ECW-H3D RHU520 | |
| 1.000 | DSV1000 | 58 | 44,0 | 200 | 5/5 | | | | | | | | | |

DSV

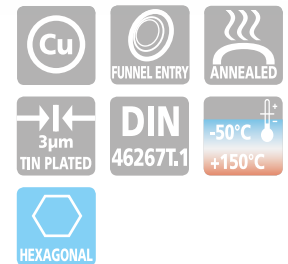

DSV series through connectors are manufactured from electrolytic Copper tube with a purity greater than 99.9%, annealed and surface protected by tin plating. Internal and external dimensions match those of DR series lugs. Chamfered ends and a central stop provide easy and correct insertion of the conductor. Details of the appropriate crimping tools and dies are shown on page 256.

Consult us for special requirements