

for Copper conductors

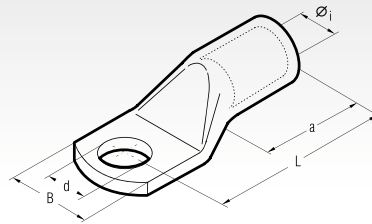

DR series lugs are manufactured from electrolytic Copper tube with a purity greater than 99.9%, and designed to obtain high electrical conductivity combined with the mechanical strength required to resist vibration and pull out.

Cembre lugs are annealed and Tin plated for improved surface protection.

The annealing process optimises the structural features of the material allowing easier crimping and greater resistance to mechanical stresses. Dimensions are according to DIN 46235.

The barrel entrance of the lug is chamfered to allow easy conductor insertion, while its length facilitates precise positioning in the crimping die.

Each lug is marked with:

- Cembre logo and part code.
- conductor type and csa (mm²).
- stud Ø (mm).
- crimping die code

Details of the appropriate crimping tools and dies are shown on page 256.

Consult us for special requirements

Conductor Size sqmm	Ø Stud mm	Type	Code	Dimensions mm					Quantity Box/Bag	Mechanical Tools	Hydraulic Tools	
				Øi	d	L	B	a				
6	5	DR6-5	5	3,8	5,3	24,0	8,5	10,0	800/100	HN-D25	B15MD	
	6	DR6-6	5	3,8	6,4	24,0	9,0	10,0	800/100			
	8	DR6-8*	5	3,8	8,4	26,0	13,0	10,0	800/100			
10	5	DR10-5	6	4,5	5,3	27,5	10,0	10,0	800/100	TND 6-70	B15MD	
	6	DR10-6	6	4,5	6,4	27,0	10,0	10,0	800/100			
	8	DR10-8*	6	4,5	8,4	28,0	13,0	10,0	800/100			
16	10	DR10-10*	6	4,5	10,5	28,5	15,0	10,0	800/100	TND 10-120	B15MD	
	6	DR16-6	8	5,5	6,4	36,0	13,0	20,0	400/100			
	8	DR16-8	8	5,5	8,4	37,0	13,0	20,0	400/100			
25	10	DR16-10	8	5,5	10,5	40,0	17,0	20,0	400/100	TND 10-120	B15MD	
	12	DR16-12*	8	5,5	13,0	41,0	19,0	20,0	400/100			
	6	DR25-6	10	7,0	6,4	39,0	14,6	20,0	400/100			
35	8	DR25-8	10	7,0	8,4	39,5	16,0	20,0	400/100	TND 10-120	B15MD	
	10	DR25-10	10	7,0	10,5	40,0	17,0	20,0	200/100			
	12	DR25-12	12	8,2	13,0	43,0	21,0	20,0	200/100			
50	16	DR25-16*	12	8,2	17,0	44,0	28,0	20,0	200/100	TND 10-120	B15MD	
	6	DR50-6*	14	10,0	6,4	52,0	20,0	28,0	100/25			
	8	DR50-8	14	10,0	8,4	52,0	20,0	28,0	100/25			
70	10	DR50-10	14	10,0	10,5	53,0	22,0	28,0	100/25	TND 10-120	B15MD	
	12	DR50-12	14	10,0	13,0	53,0	24,0	28,0	100/25			
	16	DR50-16	14	10,0	17,0	57,0	28,0	28,0	100/25			
95	8	DR70-8	16	11,5	8,4	56,0	24,0	28,0	50/25	TND 10-120	B15MD	
	10	DR70-10	16	11,5	10,5	56,0	24,0	28,0	50/25			
	12	DR70-12	16	11,5	13,0	56,0	24,0	28,0	50/25			
120	16	DR70-16	16	11,5	17,0	60,0	30,0	28,0	50/25	TND 10-120	B15MD	
	20	DR70-20*	16	11,5	21,0	84,5	30,0	28,0	50/25			
	8	DR95-8*	18	13,5	8,4	65,0	28,0	35,0	50/25			
150	10	DR95-10	18	13,5	10,5	66,0	28,0	35,0	50/25	TND 10-120	B15MD	
	12	DR95-12	18	13,5	13,0	66,0	28,0	35,0	50/25			
	16	DR95-16	18	13,5	17,0	65,5	32,0	35,0	50/25			
185	20	DR95-20*	18	13,5	21,0	71,0	33,0	35,0	50/25	TND 10-120	B15MD	
	8	DR120-8*	20	15,5	8,4	70,0	31,0	35,0	50/25			
	10	DR120-10	20	15,5	10,5	70,0	32,0	35,0	50/25			
240	12	DR120-12	20	15,5	13,0	70,5	32,0	35,0	50/25	TND 10-120	B15MD	
	16	DR120-16	20	15,5	17,0	70,0	32,0	35,0	50/25			
	20	DR120-20	20	15,5	21,0	72,0	36,0	35,0	50/25			
280	10	DR150-10	22	17,0	10,5	79,0	34,0	35,0	50/25	TND 10-120	B15MD	
	12	DR150-12	22	17,0	13,0	78,5	34,0	35,0	40/20			
	16	DR150-16	22	17,0	17,0	78,0	34,0	35,0	40/20			
350	20	DR150-20	22	17,0	21,0	78,0	40,0	35,0	50/25	TND 10-120	B15MD	
	10	DR185-10	25	19,0	10,5	83,0	37,0	40,0	25/25			
	12	DR185-12	25	19,0	13,0	82,5	37,0	40,0	25/25			
420	16	DR185-16	25	19,0	17,0	82,0	37,0	40,0	25/25	TND 10-120	B15MD	
	20	DR185-20	25	19,0	21,0	83,0	40,0	40,0	25/25			
	10	DR240-10*	28	21,5	10,5	92,0	42,0	40,0	20/10			
500	12	DR240-12	28	21,5	13,0	92,0	42,5	40,0	20/10	TND 10-120	B15MD	
	16	DR240-16	28	21,5	17,0	92,0	42,5	40,0	20/10			
	20	DR240-20	28	21,5	21,0	92,0	45,0	40,0	20/10			

* Dimensions of the tube according to DIN 46235; Stud hole not included within the standard.

COPPER TUBE CRIMPING LUGS ACCORDING TO DIN 46235

for Copper conductors

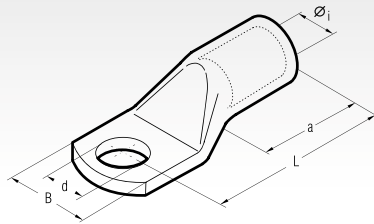

Conductor Size sqmm	Ø Stud mm	Type	Code	Dimensions mm					Quantity Box/Bag	Hydraulic Tools		
				Øi	d	L	B	a				
300	12	DR300-12*	32	24,5	13,0	104,0	47,0	50,0	10/5	RH50 B500 B500ND	HT120 and tools and heads with 130 kN crimping force	ECW-H3D RHU520
	16	DR300-16	32	24,5	17,0	100,0	48,0	50,0	10/5			
	20	DR300-20	32	24,5	21,0	100,0	47,0	50,0	10/5			
400	12	DR400-12*	38	27,5	13,0	117,0	55,0	70,0	5/5			
	16	DR400-16	38	27,5	17,0	117,0	55,0	70,0	5/5			
	20	DR400-20	38	27,5	21,0	117,0	55,0	70,0	5/5			
500	12	DR500-12*	42	31,0	13,0	130,0	60,0	70,0	5/5			
	16	DR500-16*	42	31,0	17,0	130,0	60,0	70,0	5/5			
	20	DR500-20	42	31,0	21,0	130,0	60,0	70,0	5/5			
625	20	DR625-20	44	34,5	21,0	135,0	63,0	80,0	5/5			
800	20	DR800-20	52	40,0	21,0	166,0	75,0	100,0	5/5			
1.000	20	DR1000-20	58	44,0	21,0	166,0	85,0	100,0	5/5			

* Dimensions of the tube according to DIN 46235; Stud hole not included within the standard.

DR



Consult us for special requirements

CRIMPING THROUGH CONNECTORS ACCORDING TO DIN 46267 T.1

for Copper conductors

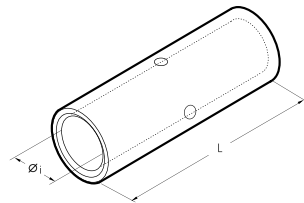

Conductor Size sqmm	Type	Code	Dimensions mm		Quantity Box/Bag	Mechanical Tools	Hydraulic Tools							
			Øi	L										
6	DSV6	5	3,7	30	1.200/100									
10	DSV10	6	4,4	30	1.200/100									
16	DSV16	8	5,5	50	400/100	HIN-D25								
25	DSV25	10	7,0	50	200/100	TND6-70								
35	DSV35	12	8,2	50	200/100	TND10-120								
50	DSV50	14	10,0	56	200/50									
70	DSV70	16	11,5	56	100/50									
95	DSV95	18	13,5	70	100/50									
120	DSV120	20	15,5	70	50/25									
150	DSV150	22	17,0	80	50/25									
185	DSV185	25	19,0	85	25/25									
240	DSV240	28	21,5	90	15/15									
300	DSV300	32	24,5	100	10/5									
400	DSV400	38	27,5	150	10/5									
500	DSV500	42	31,0	160	5/5									
625	DSV625	44	34,5	160	5/5									
800	DSV800	52	40,0	200	5/5									
1.000	DSV1000	58	44,0	200	5/5									

DSV

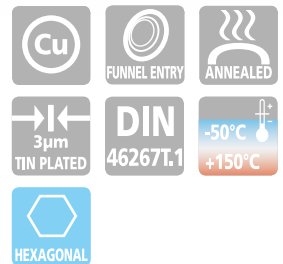

DSV series through connectors are manufactured from electrolytic Copper tube with a purity greater than 99.9%, annealed and surface protected by tin plating. Internal and external dimensions match those of DR series lugs. Chamfered ends and a central stop provide easy and correct insertion of the conductor. Details of the appropriate crimping tools and dies are shown on page 256.

Consult us for special requirements